

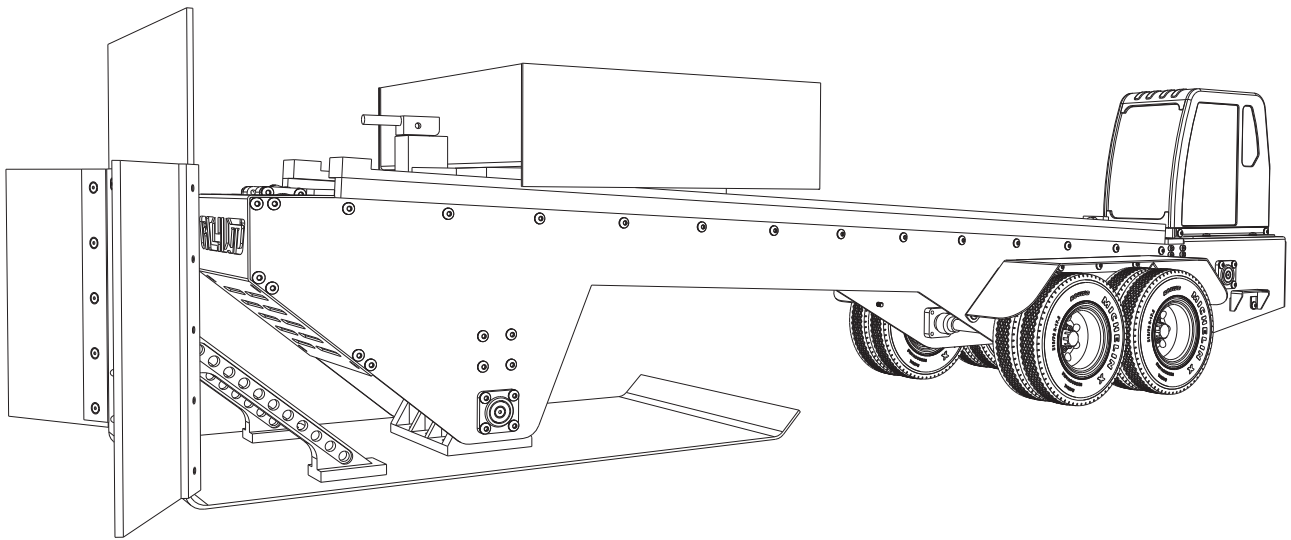

# RC4WD INTIMIDATOR PULLING SLED



## Warranty

RC4WD non-electrical products are warranted to be free of defects in materials and workmanship when new. Our limited warranty does not cover damages due to normal wear and tear, user error of assembly or installation, user modifications, user's failure to perform routine maintenance, addition of aftermarket parts or option parts. This warranty lasts 30 days after arrival for original purchaser. In the event of a defect under this warranty, RC4WD will, at our discretion, replace the product, provided our inspection indicates that an original defect exists. RC4WD reserves the right to replace any product which is no longer available with a product of comparable value and function. If RC4WD determines the repair is not covered under warranty guidelines, we will contact you to discuss your options. If you have any questions, please contact us via email at [support@rc4wd.com](mailto:support@rc4wd.com).

RC4WD warranties its electronics for 30 days from date of arrival. This covers all electrical items except items that are already noted on the individual product page.

For information regarding regulatory certifications please email [support@rc4wd.com](mailto:support@rc4wd.com).

# How to maintain your RC4WD Intimidator Pulling Sled

CAUTION: While lifting please take care. This may take 2 people to remove from the box. Use proper lifting techniques and do not over exert yourself.

To maintain the life of chain on the pulling sled it is recommended to use chain lube, or spray on lube such as WD40.

The sled features a unique mechanism for disengaging the weight hopper/container. This should be inspected before each use to make sure it is operating freely.

Check all nuts and bolts on the sled for tightness before using as things may have loosened during shipment. It is recommended that blue thread lock be used on all bolts prior to operation to ensure nothing comes apart.

This is not a toy and is not intended for use under the age of 14.

**R4WD**

**Step 1**



X10

150-0100

M3 x 8mm FHCS

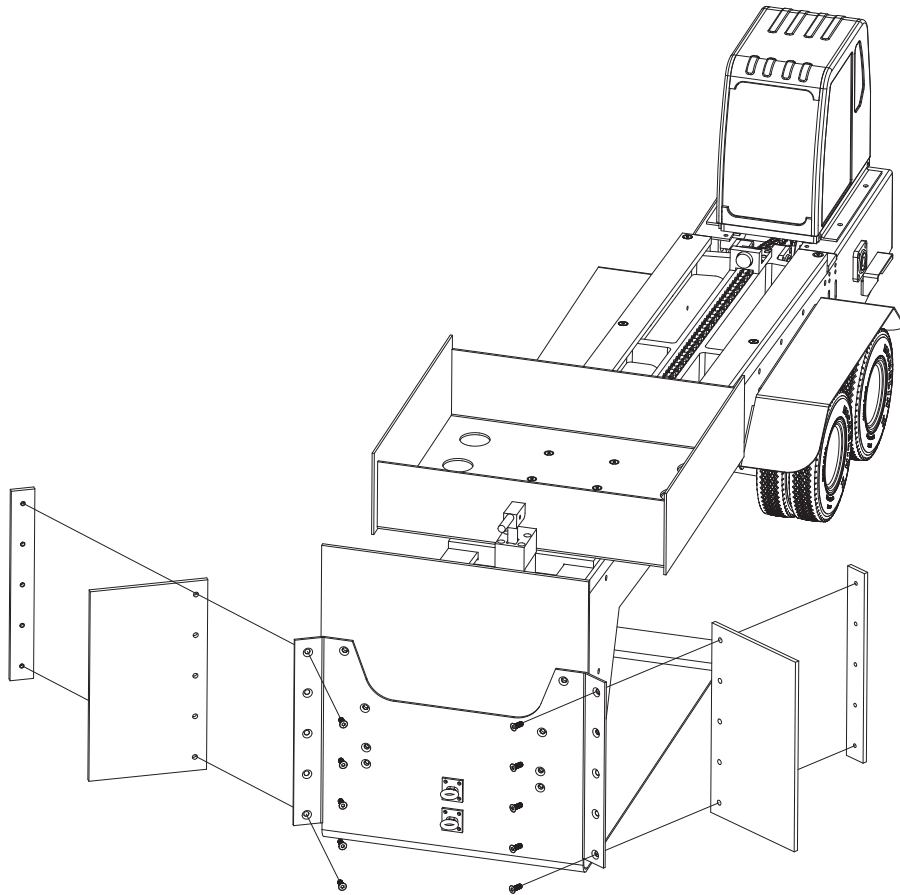

**R4WD**

**Step 2**

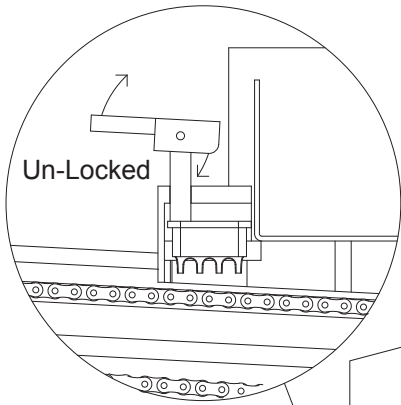

Un-Locked

To lock sled to chain, make sure the lever is in the locked position.

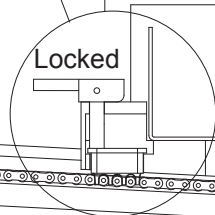

Locked

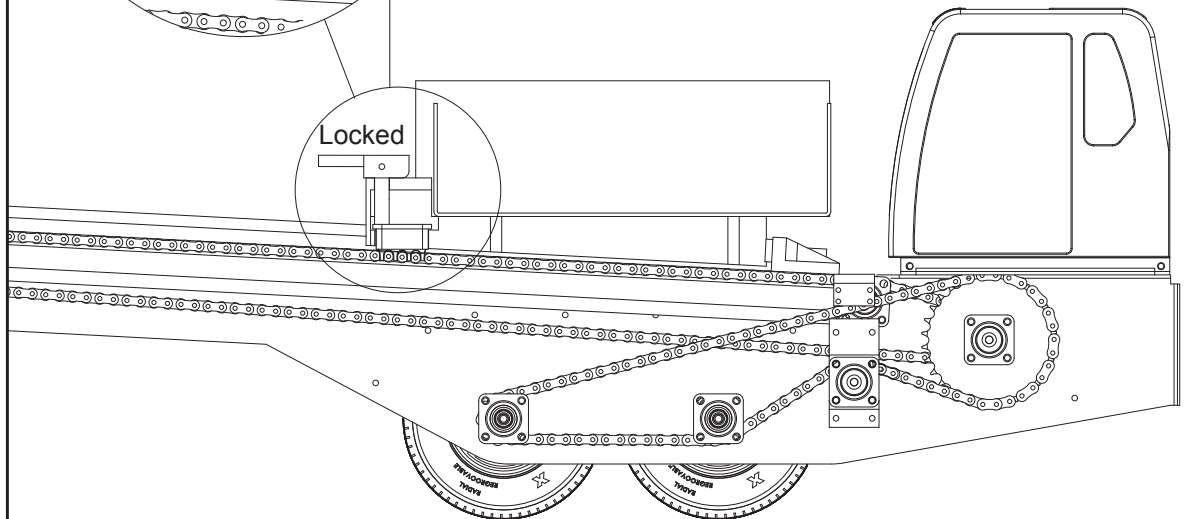

**R4WD**

**Step 3**

To move the sled back into the starting position pull the lever up. This will disengage the chain lock and the hopper can slide back into place.

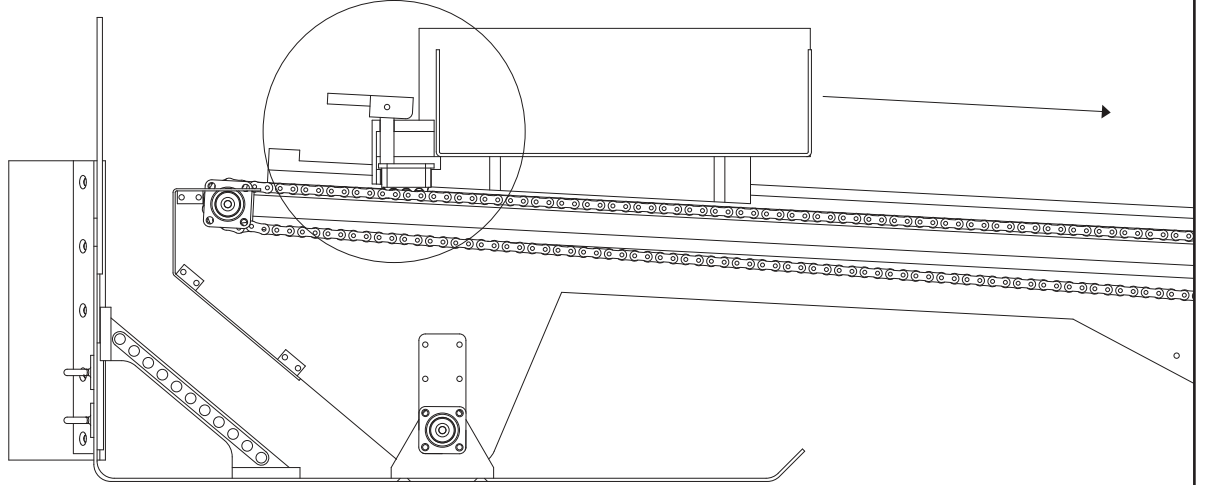

**R4WD**

**Step 4**

1. Return the Lever to the locked position

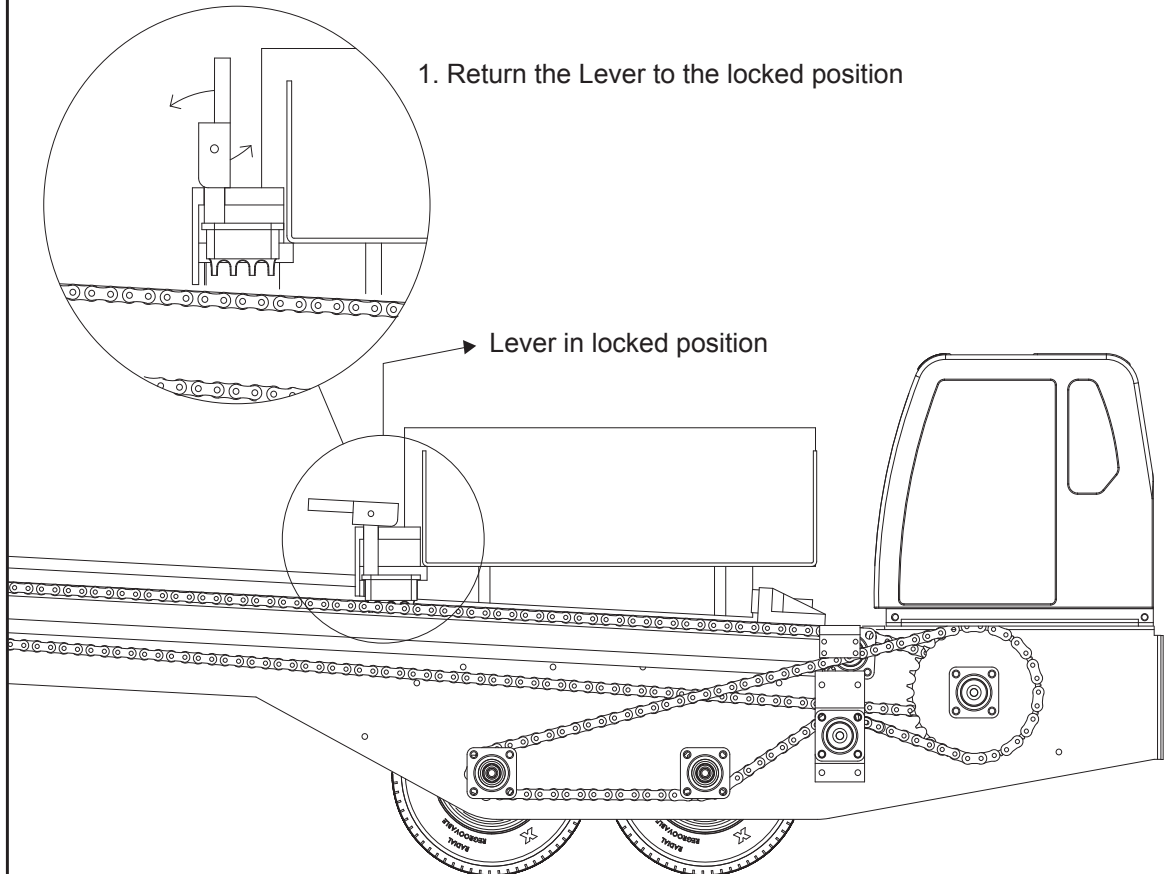

**R4WD**  
**Step 5**

When the weight has reached the top of the sled the wheels will lock creating extra drag

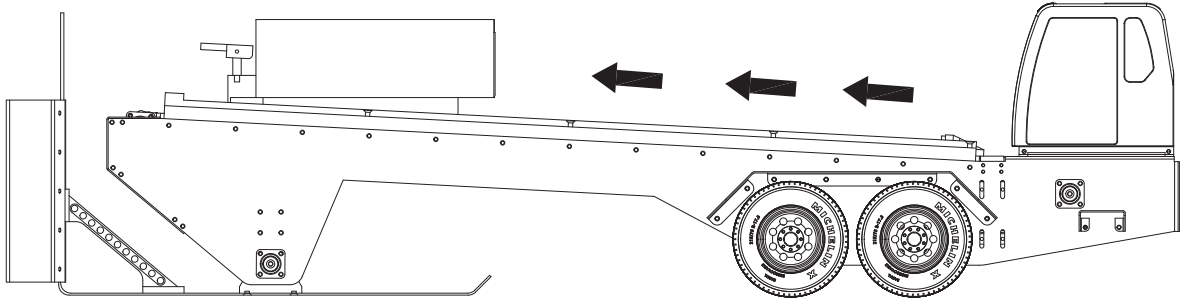

**R4WD**  
**Step 6**

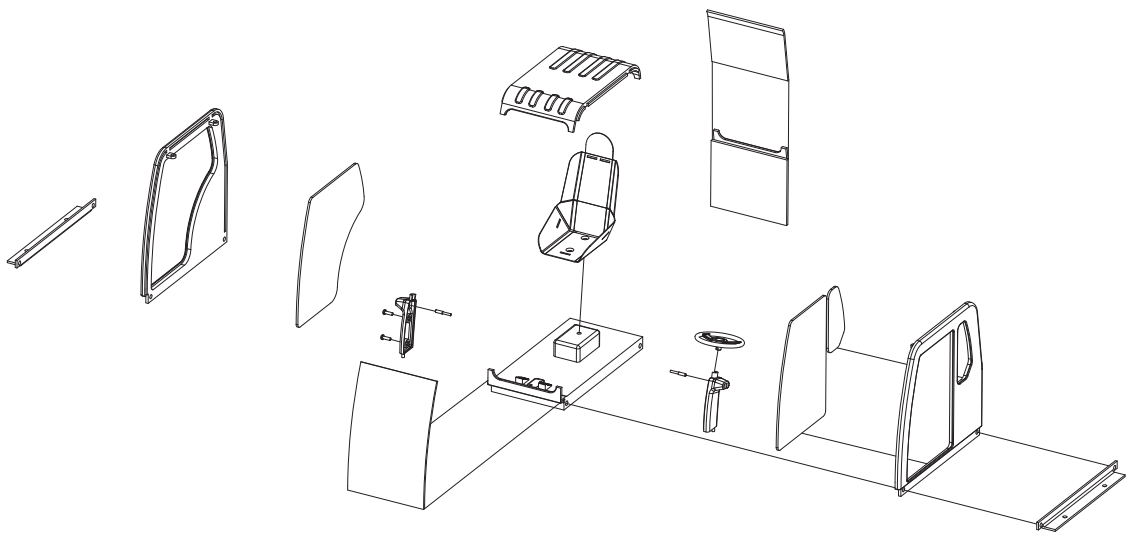

**RELOWD**  
**Step 7**

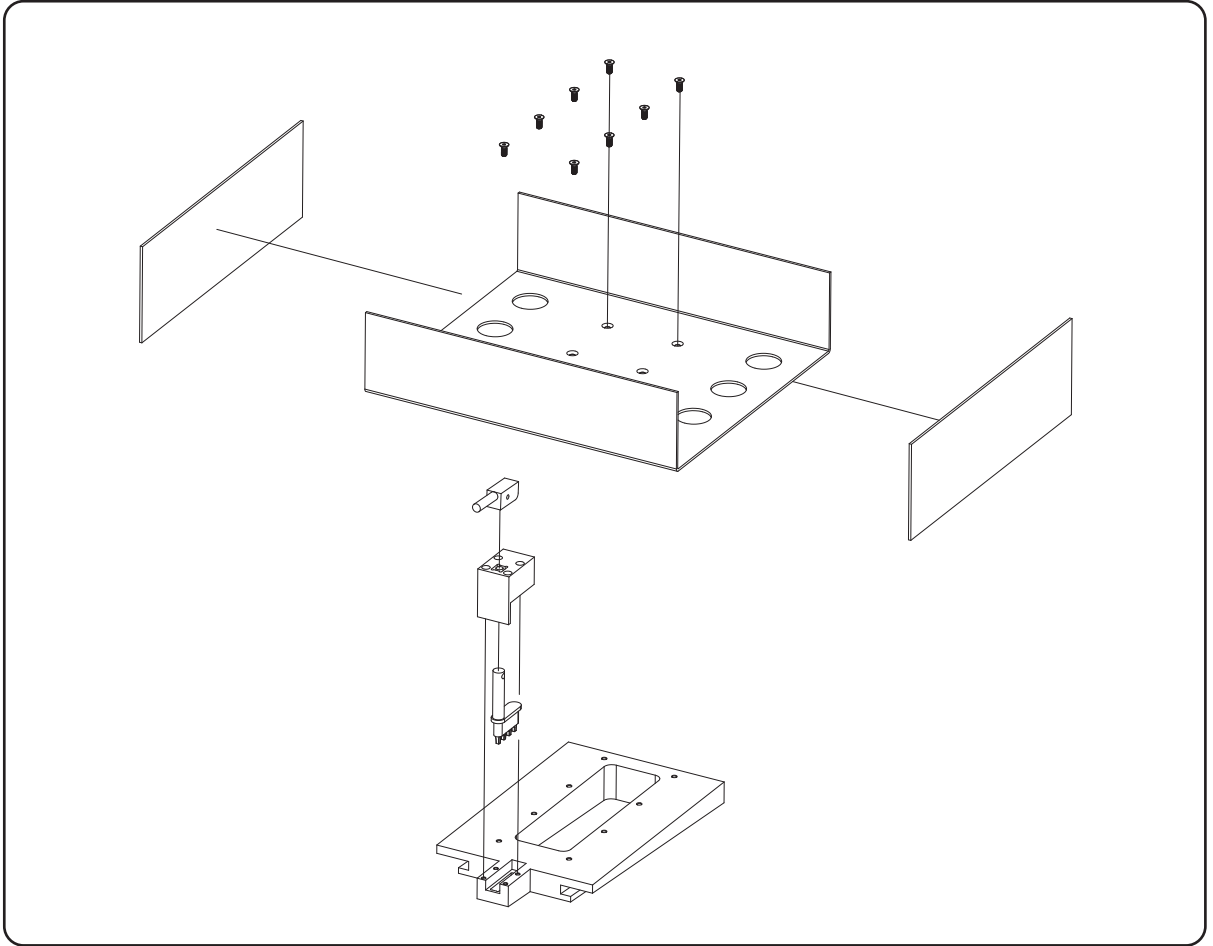

**RELOWD**  
**Step 8**

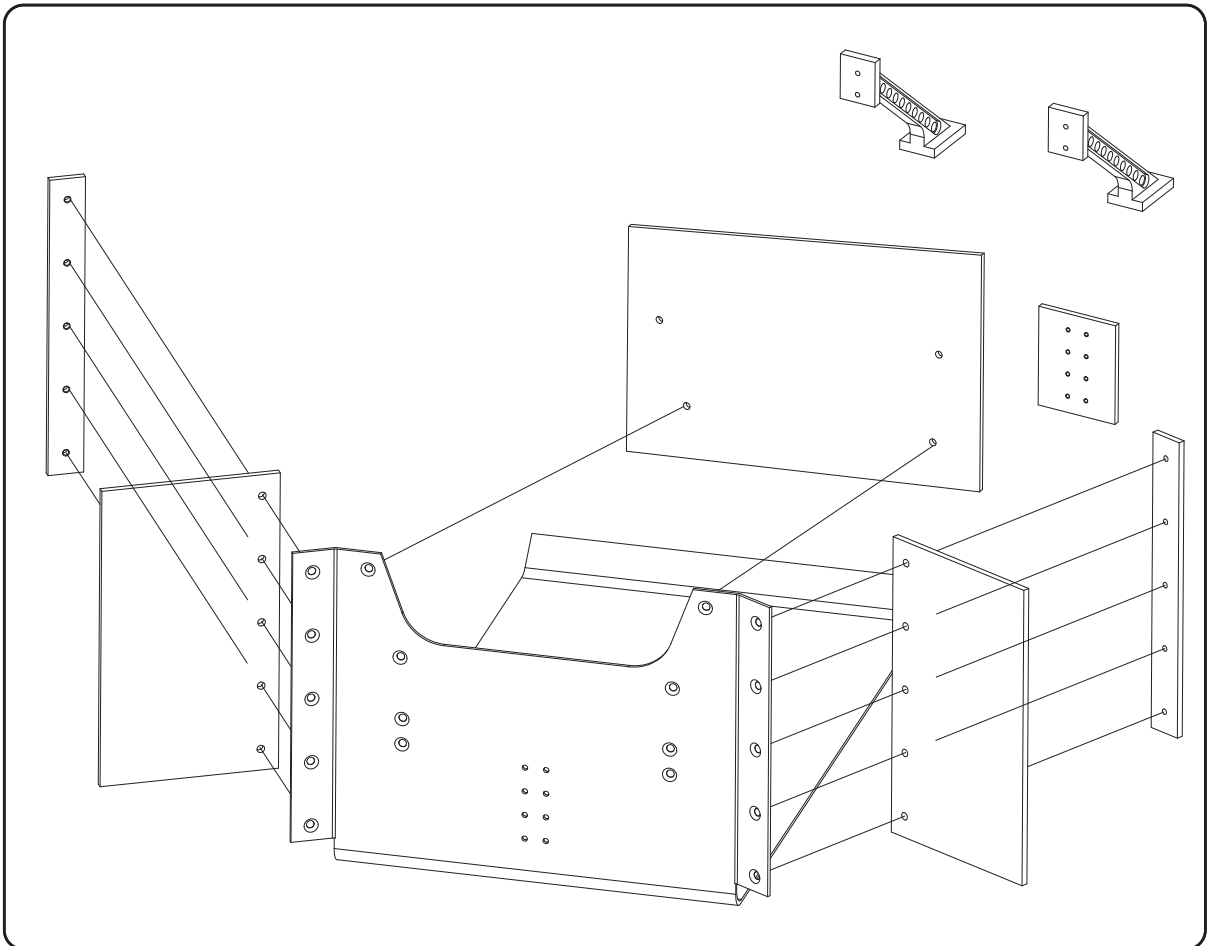

**RELUVO**  
**Step 9**

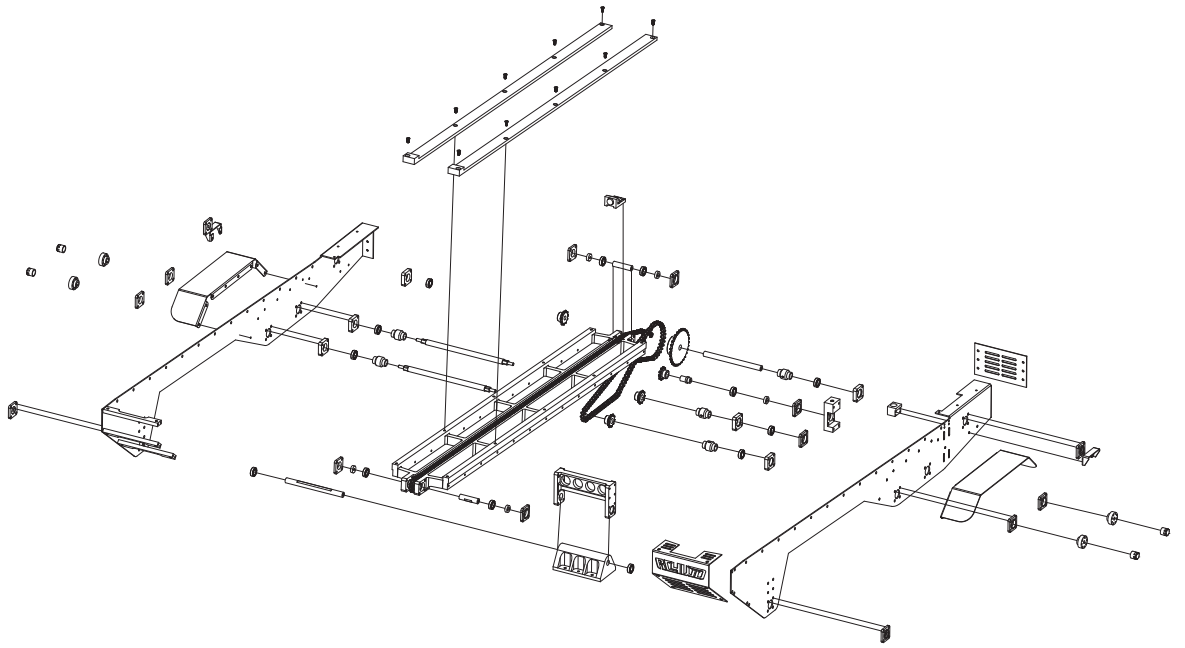



## Pulling track layout guide

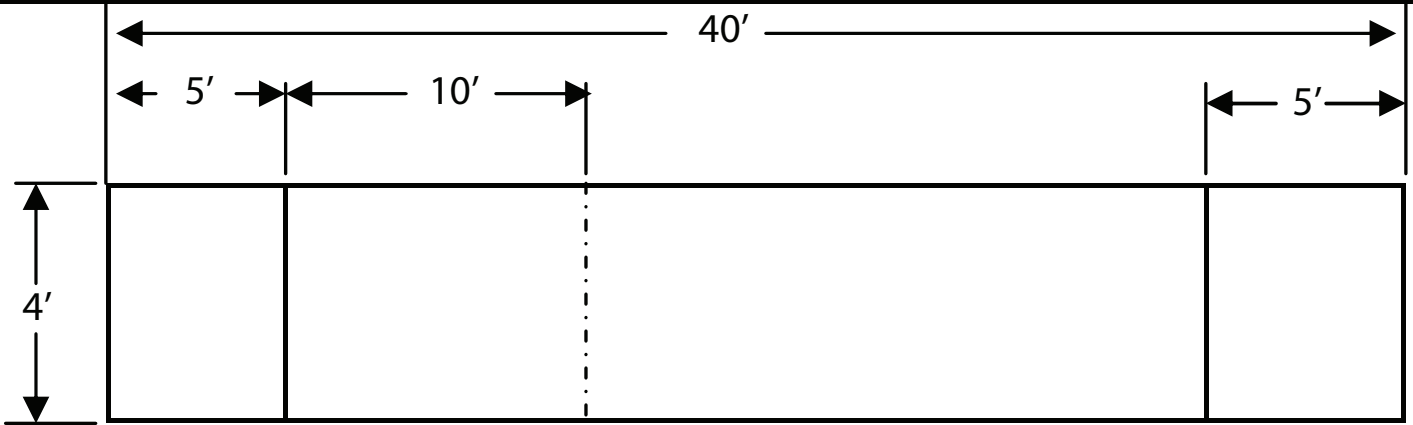

Length:

30 foot track

5 foot pull back area

5 foot runoff area

40 foot total length

10 foot default line. Measured from the starting line

Pulling direction in the image above is from left to Right

Pulling track layout provided by NR/CTPA.

More information on RC sled Pulling at [www.nrctpa.org](http://www.nrctpa.org)

# Sticker

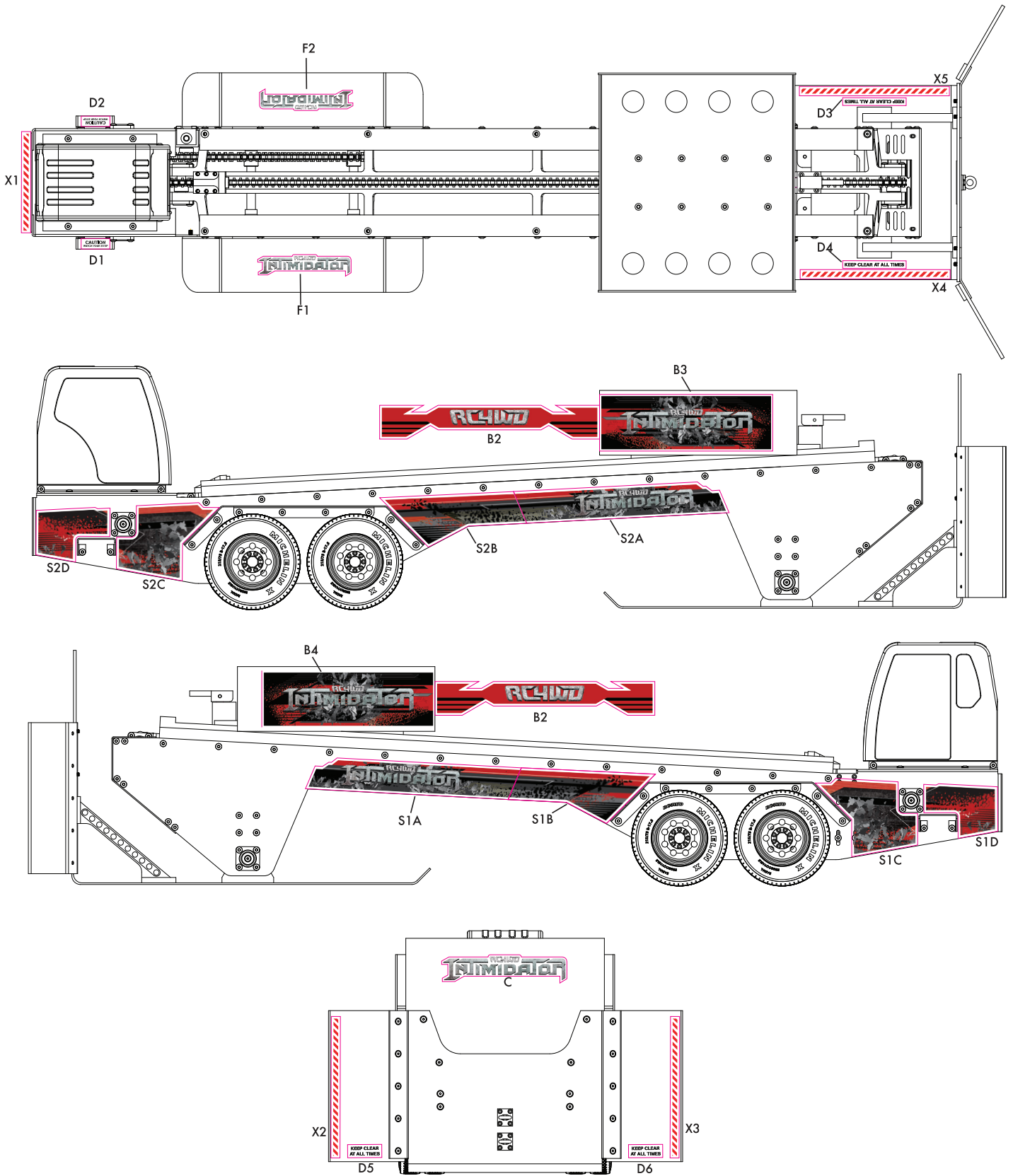



[www.rc4wd.com](http://www.rc4wd.com)



***RC4WD***

720 N. Gateway St.  
Visalia, CA 93291

Web: [www.rc4wd.com](http://www.rc4wd.com) - Email: [support@rc4wd.com](mailto:support@rc4wd.com)